

# RAILWAY GROUP D

 Mahendra's

REASONING



≡ अंतिम प्रहार ≡

# EXPECTED QUESTIONS

LIVE | 08:30 PM





# UPCOMING ONLINE BATCHES

## July 2022

**06 July 2022**

**05:30 PM to 07:30 PM**

**BANK ONLINE LIVE CLASS**

**03:00 PM to 05:00 PM**

**SSC ONLINE LIVE CLASS**

**BILINGUAL**

**06 July 2022**

**07:30 PM to 09:30 PM**

**BANK ONLINE LIVE CLASS**

**ENGLISH MEDIUM**

**06 July 2022**

**02:00 PM to 04:00 PM**

**SSC ONLINE LIVE CLASS**

**ENGLISH & BENGALI**

**13 July 2022**

**08:00 AM to 10:00 AM**

**BANK ONLINE LIVE CLASS**

**07:30 PM to 09:30 PM**

**SSC ONLINE LIVE CLASS**

**BILINGUAL**

**13 July 2022**

**09:15 AM to 11:15 AM**

**BANK ONLINE LIVE CLASS**

**ENGLISH & BENGALI**

**20 July 2022**

**01:00 PM to 03:00 PM**

**BANK ONLINE LIVE CLASS**

**10:30 AM to 12:30 PM**

**SSC ONLINE LIVE CLASS**

**BILINGUAL**

**27 July 2022**

**10:30 AM to 12:30 PM**

**BANK ONLINE LIVE CLASS**

**08:00 AM to 10:00 AM**

**SSC ONLINE LIVE CLASS**

**BILINGUAL**

**27 July 2022**

**07:00 AM to 09:00 AM**

**BANK ONLINE LIVE CLASS**

**ENGLISH & BENGALI**



[www.mahendras.org](http://www.mahendras.org)



7052477777/7052577777



Nadeem 18 hours ago

📖 Homework Answer 📝

🔴 Option B :- HA ✅

🌿 Thank You Sir 🙏 Awesome Session Sir 🥰🌿🎉

👍 1 🗨️ REPLY ▶️



Chhavi Saxena 20 hours ago

Home work answer is option B (HA)

Logic - 26 so  $2^2$  means 64 and 34 so  $3^4 = 81$  then home work answer will be (HA)

Very Nice session Sir Thank you so much dear Sir 🙏🙏🙏🙏🙏🙏🙏🙏🙏🙏

👍 1 🗨️ REPLY ▶️



🌸 PUJA KUNDU 🌸 20 hours ago 7 subscribers

THE ANSWER IS---HA....3 D =3 4,..... $3^4=81$ ==HA....THANK YOU SOO MUCH SIR..TABIYAT KHARAP HOTE HUYE BHI APNE CLASS LI 🙏🙏🙏🙏🙏🙏

👍 1 🗨️ REPLY ▶️



Vishnu Gupta 20 hours ago 3 subscribers

HA is the right ans very super nice session sir Thank you 🙏 sir love you sir ❤️🙏

👍 1 🗨️ REPLY ▶️



Ankit Vish 20 hours ago 216 subscribers

Answer. BBB

Lajwab session sir 🙏🙏

👍 2 🗨️ REPLY ▶️



arun ch mandal 1 hour ago

HW is HA

thank you sir

nice session

👍 🗨️ REPLY ▶️



SANIA 11 hours ago

Mast session sir 🙏🙏  
HA🔥🔥🔥

👍 1 🗨️ REPLY 📧



fav. e 20 hours ago  
41

👍 🗨️ REPLY 📧



fav. e 20 hours ago  
2

👍 🗨️ REPLY 📧



fav. e 20 hours ago  
1

👍 🗨️ REPLY 📧



fav. e 20 hours ago  
Hii

👍 🗨️ REPLY 📧



kuldeep singh 6 hours ago  
HA

👍 🗨️ REPLY 📧



CHANDAN GUPTA 20 hours ago [29 subscribers](#)

SIR SIR HI

👍 1 🗨️ REPLY 📧

▼ [View 8 replies](#)



Find the missing one (?)

2F : FD :: 3D : ?

- (A) HU
- (B) HA
- (C) HO
- (D) HI





**Find the missing :-**

**441 : 7 :: 361 : ?**

- (A) 8**
- (B) 9**
- (C) 10**
- (D) 12**





Find the missing :-

1921: EO :: 159 : ?

- (A) AF
- (B) OU
- (C) EA
- (D) OP





Find the missing :-

- (A) 05
- (B) 00
- (C) 10
- (D) 04

00	05	?
06	15	20
08	04	05
03	05	20







**Find the missing :-**

**RAT : 912 :: HUT : ?**

- (A) 82020**
- (B) 833**
- (C) 1962**
- (D) 823**





**Statement :-**

**All Women are Doctors . / सभी महिलाएं डॉक्टर्स हैं।  
Some Doctors are Advocate./ कुछ डॉक्टर एडवोकेट हैं।**



**Conclusion:-**

**All Doctors are Women . / सभी डॉक्टर महिलाएं हैं।  
Some Women are advocate . / कुछ महिलाएं वकील हैं।  
No Women are Advocate./ कोई भी महिला एडवोकेट नहीं हैं।**



Find the SQUARE :-

- (A) 9
- (B) 8
- (C) 7
- (D) 10

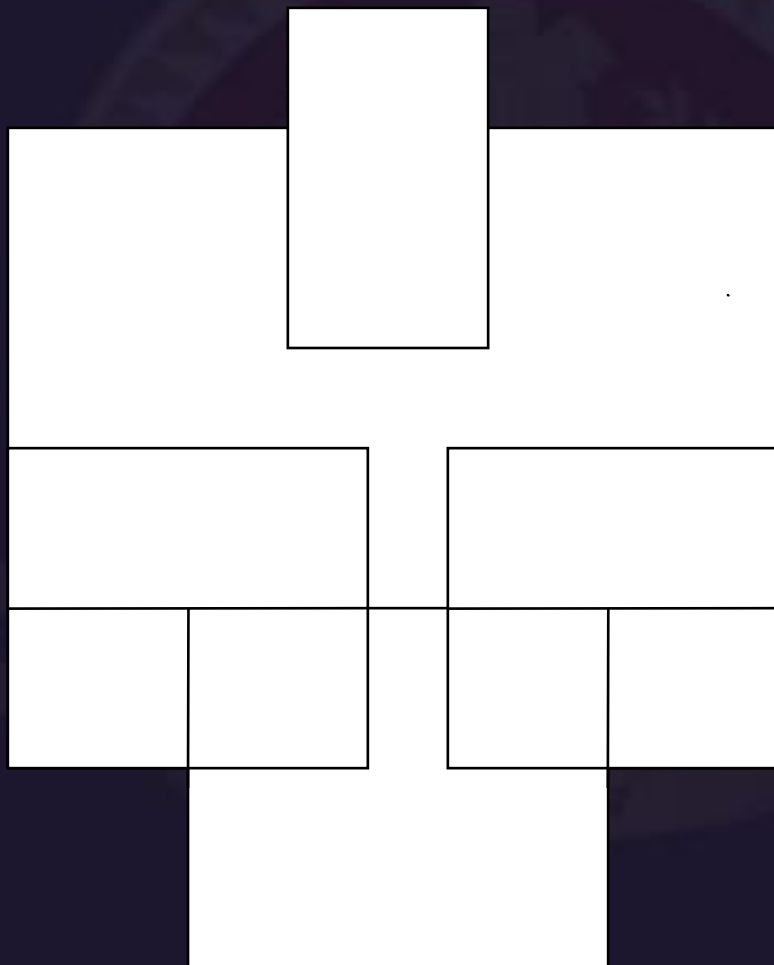



Find the MISSING (?)



169 : 10 :: 144 : ?

1. 8
2. 12
3. 18
4. 6



Statements: कथन :

Some politician are sinister./ कुछ राजनेता पापी होते हैं।  
All sinister is a bureaucrats. / सभी पापी नौकरशाह हैं।



Conclusions: निष्कर्ष:

- I. Some bureaucrats are not sinister./ कुछ नौकरशाह पापी नहीं हैं।
- II. No politician is a bureaucrats. / कोई भी राजनेता नौकरशाह नहीं है।



Find the option which should replace (?)

25 : 64 :: 35 : ?

- (A) 64
- (B) 81
- (C) 72
- (D) 100





Find the triangle :-

- (A) 09
- (B) 10
- (C) 11
- (D) 12

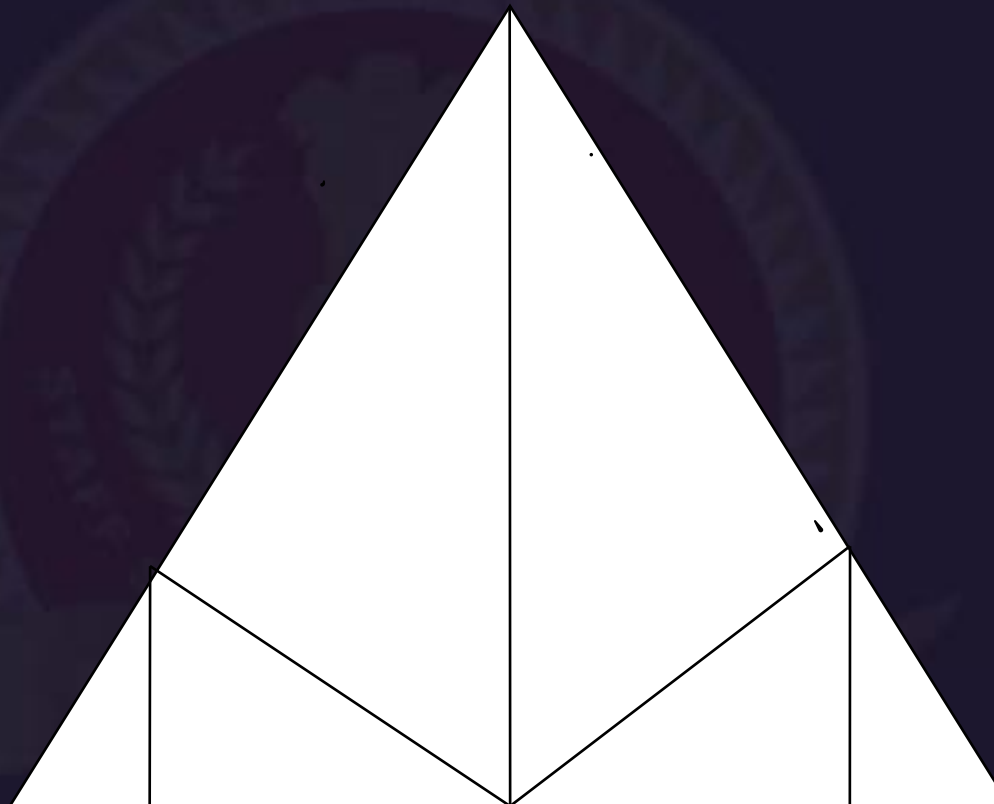



**Find the odd (?)**

- (A) Vitamin A : Loss of vision**
- (B) Vitamin B : Beriberi**
- (C) Vitamin K : Haemorrhage**
- (D) Vitamin D : Peralysis**







A is brother of C . D is wife of M who is only son of N .C is daughter of D. How is N related to A ?  
A, C का भाई है। D, M की पत्नी है जो केवल N का पुत्र है। D, D की बेटी है। N, A से कैसे संबंधित है?

- (A) Father / पापा
- (B) Grandfather / दादा
- (C) Uncle / चाचा
- (D) CND / CND





Find the option which should replace (?)

- (A) 25
- (B) 20
- (C) 22
- (D) 13

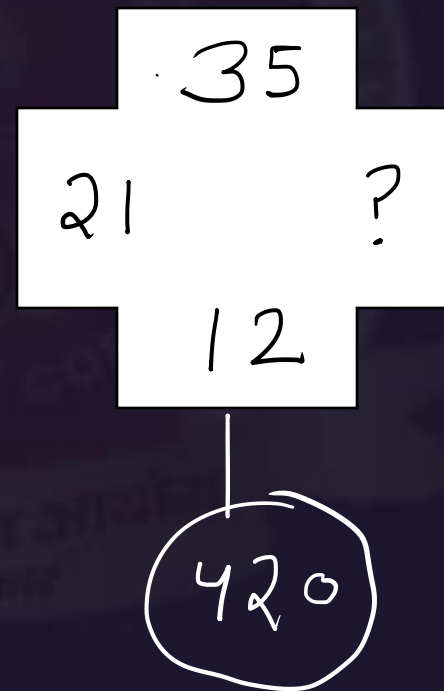
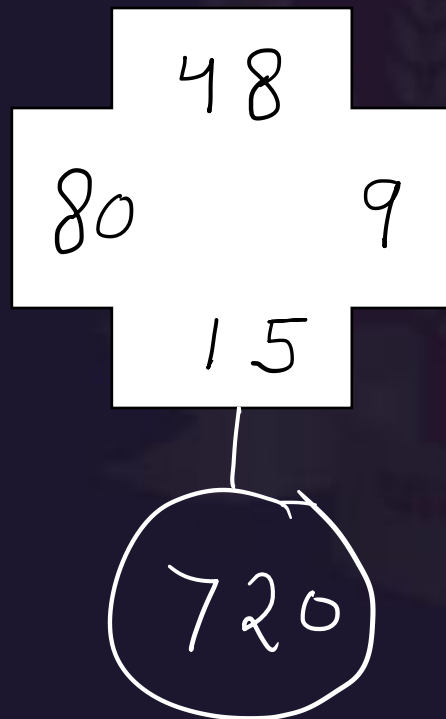



Find the in Dictionary order :-

1. Wrist / कलाई
2. Nails / नाखून
3. Shoulder / कंधा
4. Elbow / कोहनी
5. Palm / हथेली
6. Fingers / उँगलियाँ

A- 1 ,2,4,3,5,6

B- 3,4,1,5,6,2

C- 1,2,3,4,5,6

D- 2,1,4,3,5,6





Find the missing (?)

$$120 * 256 * 32 * 40 * 88$$



(A) -  $\div$  = +

(B) + = -  $\div$

(C) + -  $\div$  =

(D) +  $\div$  - =



Find the missing (?)

$$4 @ 5 = 209$$

$$6 @ 7 = 601$$

$$8 @ 2 = ?$$

(A) 620

(B) 495

(C) 540

(D) 536





**Find the missing (?)**

**RELATIVE = MFSCVHYL**  
**NUMBERED = ?**



- (A) NVOCFSFE**
- (B) NVODGGHU**
- (C) NVOGDSFE**
- (D) NVOCFDGG**



**Find the missing (?)**

**47 , 57 , 69 , 85 , ?**

- (A) 109**
- (B) 101**
- (C) 92**
- (D) 95**





Find the missing (?)

Mahatma = Rabindranath Tagore / महात्मा = रवींद्रनाथ टैगोर  
Netaji = ? / नेताजी = ?

- (A) Gandhi / गांधी
- (B) Naroji / नरोजी
- (C) Hitler / हिटलर
- (D) Devdutt / देवदत्त

